

JAPAN P&I NEWS

No.716-15/02/25

To the Members

Dear Sirs,

Recent Navigation Warnings of China Waters No.30

Please refer to our Japan P&I News No.714 dated 2 February, 2015. We have obtained additional information on recent navigation warnings of China Waters issued by MSA China. Please find attached the free translation received from the law firm in Shanghai, China, Sloma & Co.

We hope it will be of help to you with regard to the safe voyaging.

Yours faithfully,

The Japan Ship Owners' Mutual Protection & Indemnity Association

Loss Prevention and Ship Inspection Department

Tel: +81 3 3662 7229

Fax: +81 3 3662 7107

E-mail: lossprevention-dpt@piclub.or.jp

Website: <https://www.piclub.or.jp>

Navigation Warning and Notice to Mariners No.30

1. Detection operation on Pinghu Oil Gas Submarine pipelines

(Sloma Translation)

ZHH (2015) No.21

MSA China 12 February 2015

I. Work duration: 14 February 2015 – 31 May 2015.

II. Work site: water areas in north of Qingbin Island of Zhoushan sea area, which is centered by 30°13'58"N / 122°42'46"E (2000 National Geodetic Coordinate System), in a radius of 500m.

III. Work boat and mode: "Juli" will conduct detection operation on the submarine pipelines in the above water area. Work boat will drop horoscopes anchors at the bow and stern of the boat, each anchor hawser is 1000 meters in length. "Zhong Hai You 251" and "Yan Shen 1098" will conduct supporting operation in the work site.

IV. Cautions:

1. Workboats should exhibit signals in accordance with Regulation on Signal Exhibition in Coastal Port and keep watch on VHF 16.
2. Passing vessels should strengthen duties and lookout, keep VHF16 clear and keep a safety distance with the work boats and pass-by slowly.
3. There are guard ships (contact with VHF 16) performing security duties on site, any vessels sailing near the work area should obey the command of the on-site guard ships.

<http://www.msa.gov.cn/Notice/Notice/5d8b565b-ff04-4013-bb12-2eba3cca6753>

2. Geological exploration operation at the nearby water areas of Daxiao Yushan of Zhoushan sea area

(Sloma Translation)

ZHH (2015) No. 14

MSA China 2 February 2015

I. Work duration: 24 January 2015 – 31 May 2015.

II. Work site: at the vicinity of Daxiao Yushan of Zhoushan sea area, which is the water area bounded by the following coordinates (2000 National Geodetic Coordinate System):

A: 30°20'38"N / 121°56'04"E;

B: 30°20'46"N / 121°58'48"E;

C: 30°18'53"N / 121°59'54"E;

D: 30°17'10"N / 121°58'49"E;

E: 30°17'17"N / 121°57'07"E;

F: 30°18'41"N / 121°54'48"E.

III. Work mode and vessels: "Zhe Pu Gong 9", "Rui Chang 319", "Zhe Ding Gong 11" and "Zhe Ding Gong 12" will conduct geological exploration in the above water areas and drop horoscopes anchors at the bow and stern of the boat, each anchor chain is 100 meters in length.

IV. Cautions:

1. Workboats should exhibit signals as regulated and keep watch on VHF 16.
2. Irrelevant vessels are forbidden to enter into the work site.
3. Passing vessels should strengthen duties and lookout, keep a safety distance from the workboats and pass-by slowly.

<http://www.msa.gov.cn/Notice/Notice/0536e0b3-40c4-45aa-be04-296444c765a6>

3. Well exploration of Well PL7-6-1

(Sloma Translation)

JDJHS (2015) HZ NO.5

MSA China 13 February 2015

Well drilling platform “Bo Hai No.7” and M/V “Bin Hai 291” will conduct well exploration operation in area centered by Well PL7-6-1 (38°38'46.962"N / 120°02'51.705"E), in a radius of 500m from 13 February 2015 to 30 March 2015. During the operation, apart from the large number of work lights at night, there is a red strobe light and a Morse (U) fog horn of 30 seconds set on the top of the derrick, a Morse (U) white-light lamp of 15 seconds (flash simultaneously) set outboard of each spud leg of the platform. Workboats should keep 24-hour watch on VHF16 and VHF67.

<http://www.msa.gov.cn/Notice/Notice/fb72022c-da61-4d5c-bd1c-7b47f76a462d>

4. Circular on announcing the No.7 and No. 8 Temporary Anchorage in Dagang port area of Tianjin Port and cancelling the No. 5 Temporary Anchorage of Tianjin Port and Temporary Anchorage of Tianjin Nangang Industrial Zone

(Sloma Translation)

JHS (2015) HZ No.2

MSA China 12 February 2015

In order to meet the needs of port development of Tianjin Port and vessel's anchoring safety and ease the tension of short supply of anchorage, we now hereby announce the relevant data of the specified No.7 and No.8 Temporary Anchorage in Dagang Port area of Tianjin Port as follows:

I. No.7 Temporary Anchorage in Dagang port area of Tianjin Port is bounded by the following six points:

A1: 38°44'58.0"N / 117°56'03.0"E;

B1: 38°44'55.0"N / 118°02'57.0"E;

C1: 38°41'40.0"N / 118°02'54.0"E;

D1: 38°41'44.0"N / 117°56'00.0"E;

E1: 38°43'05.6"N / 118°02'55.3"E;

F1: 38°43'05.9"N / 117°56'01.3"E.

The anchorage covers an area of 60 square kilometers, the water is 8.9~12.9m deep, bottom characteristic is mainly clay. Bordered by points of E1 and F1, area of 35 square kilometers in the north is anchorage zone for vessels carrying non-dangerous goods, area of 25 square kilometers in the south is anchorage zone for vessels carrying dangerous goods.

II. No.8 Temporary Anchorage in Dagang port area of Tianjin Port is bounded by the following six points:

A2: 38°42'24.0"N / 118°13'21.0"E;

B2: 38°42'21.0"N / 118°18'52.0"E;

C2: 38°39'22.0"N / 118°18'48.0"E;

D2: 38°39'26.0"N / 118°13'18.0"E;

E2: 38°41'40.0"N / 118°18'50.8"E;

F2: 38°41'43.0"N / 118°13'19.8"E.

The anchorage covers an area of 44 square kilometers, the water is 14.5~17.4m deep, bottom characteristic is mainly clay. Bordered by points of E2 and F2, area of 10 square kilometers in the north is anchorage zone for vessels carrying dangerous goods, area of 34 square kilometers in the south is anchorage zone for vessels carrying non-dangerous goods.

Please see the Appendix I and Appendix II for the No.7 and No.8 Temporary Anchorage and their functional partition.

III. Cautions:

1. Vessels should choose the appropriate anchoring berth to drop anchors based upon the type and draft of the vessels and sea conditions to maintain enough under-keel clearance.
2. After anchoring, vessels should report to the Maritime Department through VHF08 and other effective ways; display lights and shapes as regulated; strengthen duties and communication, focus on the surrounding wind and flow conditions, implement various safety measures and ensure the safety of the anchorage.
3. “No.5 Temporary Anchorage of Tianjin Port” promulgated in the Announcement of the Relevant Data of Tianjin Lingang Port Area (JHS (2007) HZ No.10) and “Temporary Anchorage of Tianjin Nangang Industrial Zone” promulgated in the Announcement of the Relevant Data of Tianjin Nangang Industrial Zone (JHS (2011) HZ No.68) are cancelled as of the date of the promulgation of this announcement.

Appendix I (Original Chinese version only. Please see attached.)

Location map of the No.7 and No.8 Temporary Anchorage in Dagang port area of Tianjin Port

Appendix II (Original Chinese version only. Please see attached.)

Functional partition diagram of the No.7 and No.8 Temporary Anchorage in Dagang port area of Tianjin Port

<http://www.msa.gov.cn/Notice/Notice/e1eda73c-6523-424c-8ed5-eabd3d3f88db>

DISCLAIMER

Please be advised that all the above navigation warnings were the important pieces selected from the official website of MSA China or that of other local MSAs. Sloma shall not be liable for the veracity of the above navigation warnings or the accuracy of their English translations. Neither shall Sloma be liable for any person's/party's possible losses/damage which may result from relying upon the above navigation warnings.

Junmao Jiang
Sloma & Co.
17 February 2015

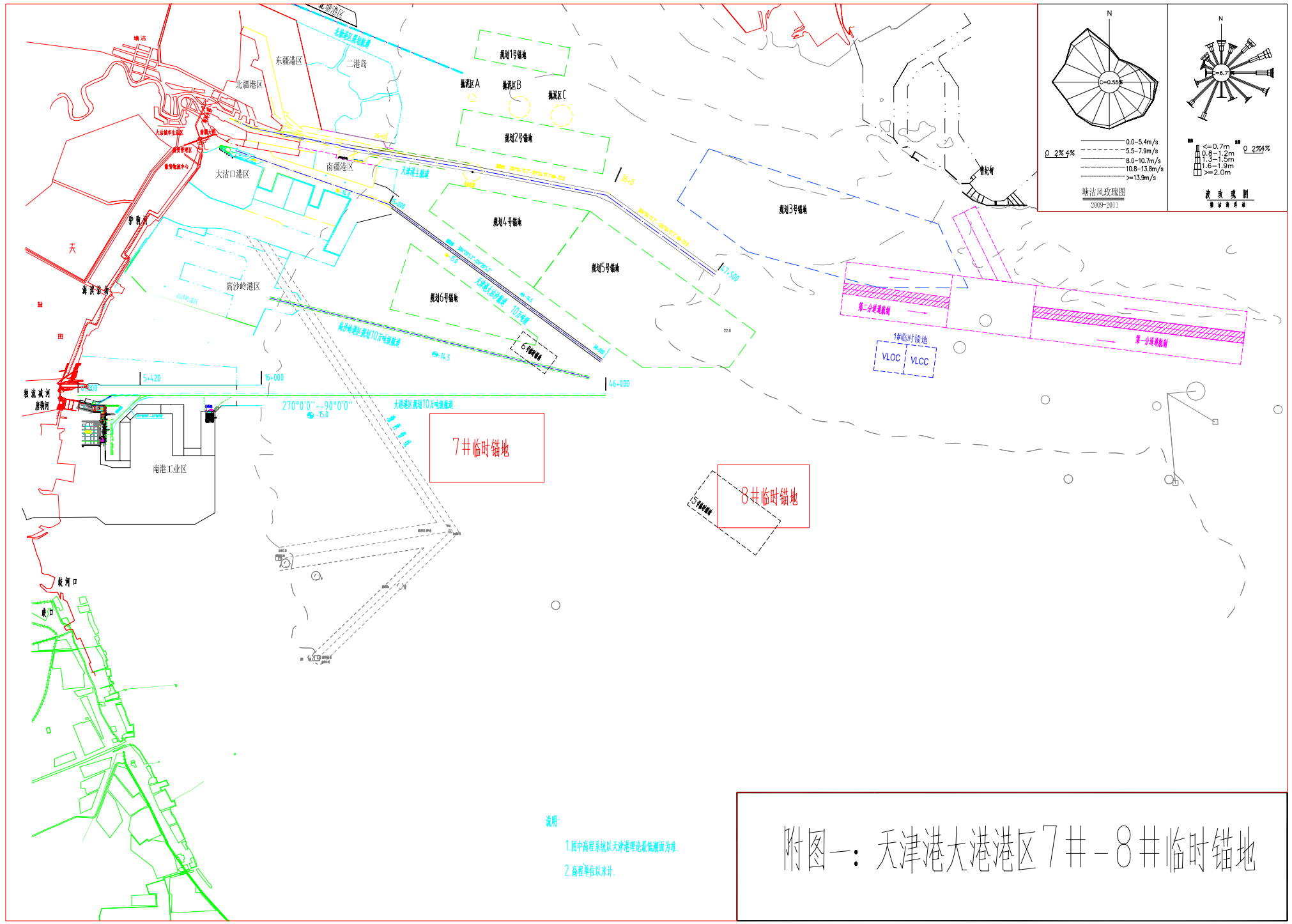

说明:
 1. 图中高程系统以天津港理论最低潮面为准。
 2. 高程单位以米计。

附图一：天津港大港港区7#-8#临时锚地

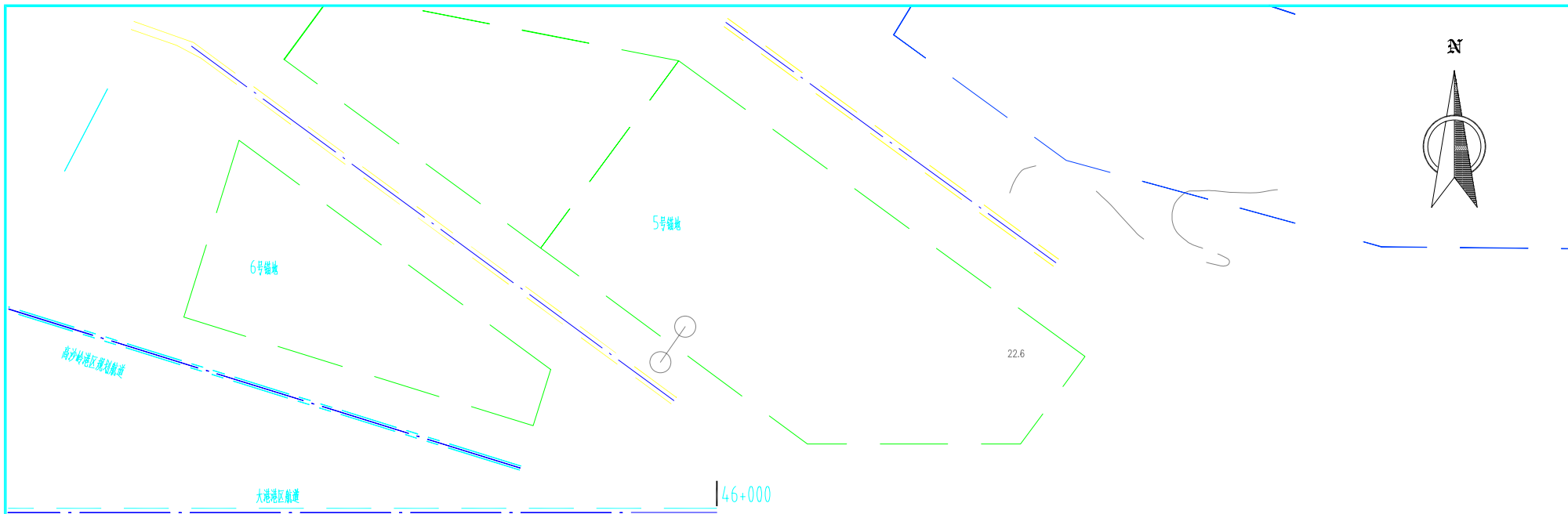

270°0'0" -- 90°0'0" -15.0

海河停泊区

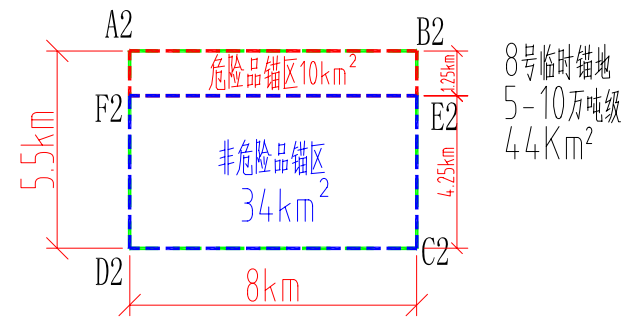
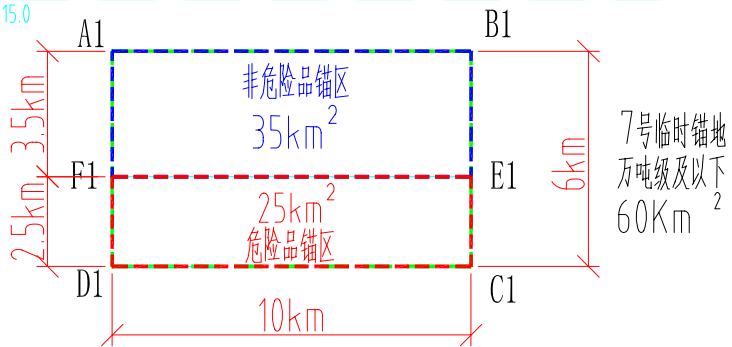

说明:

- 1 图中高程系统以天津港理论最低潮面为准。
- 2 高程 尺寸单位以米计。
- 3 锚地选划位置与已批复的天津港总体规划一致。

附图二：天津港大港港区7井-8井临时锚地功能划分示意图